

## ILTC – Inset LED Taxiway Centerline, Stop Bar and Intermediate Holding Position Light

### STANDARDS

- ICAO Annex. 14 Volume I
- EASA: CS-ADR-DSN
- IEC: TS 61827
- EASA: CS-ADR-DSN
- FAA AC 150/5345-46 & EB67
- CAP 168
- STANAG 3316



### APPLICATIONS

Taxiway centerline, stopbar and intermediate holding position for ICAO CAT I,II and III, FAA and military taxiways, in compliance with ICAO, Annex 14, Vol. I, Figures A2-12, A2-13, A2-14, A2-15 & A2-16

### CHARACTERISTICS

- Color emitted directly by the LED sources without the need of filters.
- Fully compatible with existing AGL infrastructure.
- 8" IEC aluminum casting with only 6,35mm protusion above the finish pavement grade.
- Lights available for unidirectional or bidirectional applications.
- Not require optical adjustment after LED modules or Lens replacement.
- No negative slope, to avoid water and dust deposits.
- Light output equivalent to a halogen lamp as per FAA EB67E.
- Surge protection device provided in the electronics as required by the FAA EB67E.
- Pressure Valve for water tightness test after production or overhaul.
- Optional Monitoring device (FOD)
- Optional Artic Kit

### TECHNICAL PARAMETERS

- Power: 2.8A ~ 6.6A or new LCLL (Low current-Low Losses system) available.
- Lifetime 60.000h at maximum brightness and 100.000h in a normal operating.
- Colors: Green, Yellow & Red
- Power Consumption: Bidirectional 12VA. Unidirectional 7VA
- Protection Index: IP68.
- Power factor > 0,97
- Working temperature: -55°C to +55°C

# ILTC – Inset LED Taxiway Centerline, Stop Bar and Intermediate Holding Position Light

## PHOTOMETRIC PERFORMANCE

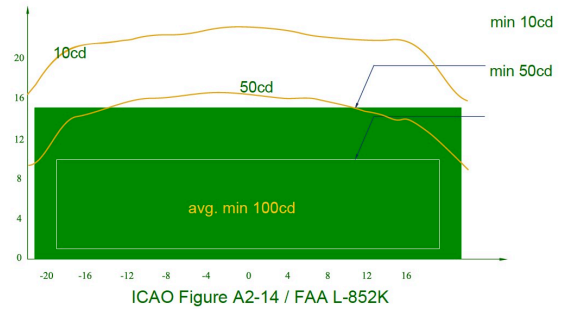
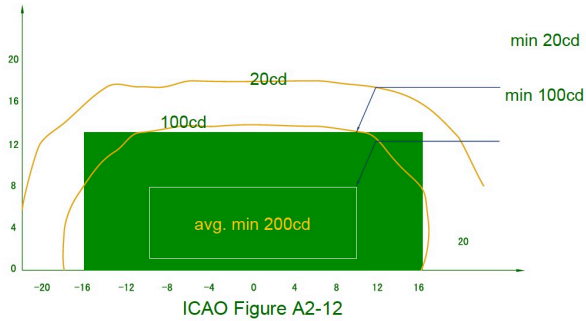

## INSTALLATION

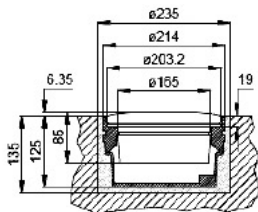

ON 8" SHALLOW BASE

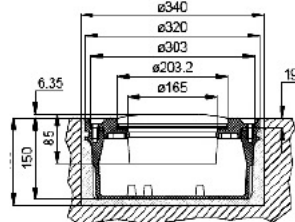

ON 12" SHALLOW BASE WITH  
 12"/8" ADAPTOR RING

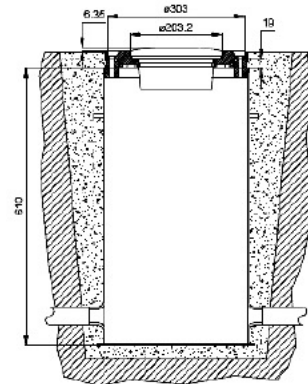

ON 12" DEEP BASE WITH 12"/8"  
 ADAPTOR RING

## PACKAGING

	PACKAGING SIZE	WEIGHT
LIGHT	22cm x 22cm x 10cm	3,5 Kg
8" SHALLOW BASE	24cm x 24cm x 15cm	6,5 Kg

## ILTC – Inset LED Taxiway Centerline, Stop Bar and Intermediate Holding Position Light

### ORDERING CODE

#### ILTC / X / AB / XX / XX / X

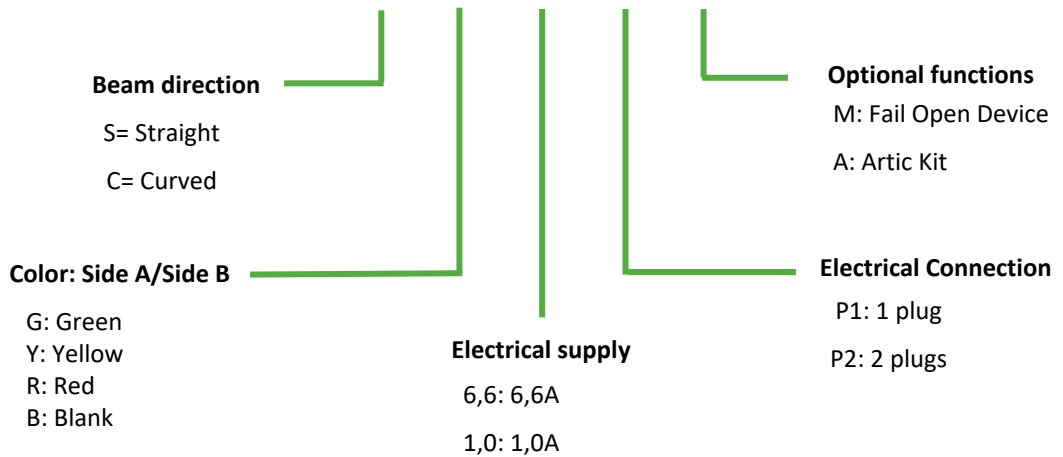

### EXPLODED VIEW

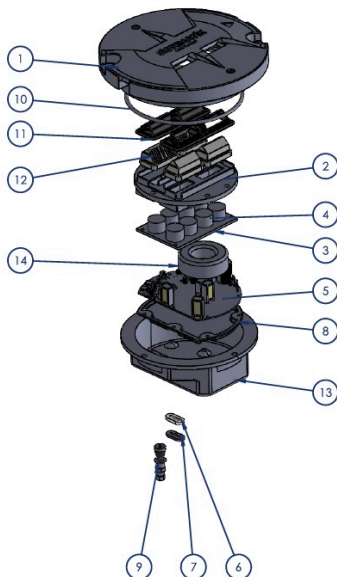

1. Upper casting
2. Lower casting
3. Led Board
4. Led Lens
5. Driver
6. Transition Rubber Cover
7. Bottom Boiler
8. Driver Gasket
9. Air Valve Seal
10. Oring
11. Gasket
12. Prism Gasket
13. Bottom Boiler
14. Transformer